

Air-driven pump for high viscosity materials Suction-type supply pump

SOSEY RECIPROCATING CAN PUMP

SRCP Series

High-viscosity material supply pump

MODEL SRCP-101N/103N/105N/1800N

features an air-driven piston pump.
It allows for the direct high-pressure
delivery of high-viscosity materials such
as grease, adhesives, sealants, etc.,
from material containers.

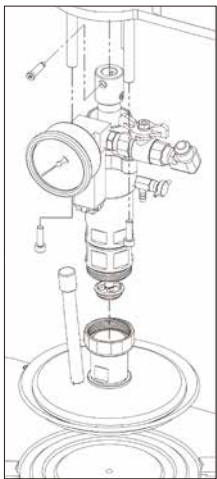

The air motor and piston pump
can be separated, providing
excellent maintenance capability.

It can operate solely on compressed
air, requiring no electrical power.

※If there are no additional
specifications, such as lower
limit detection, etc.



High-pressure delivery and supply of adhesives and
sealants for bonding solar cell frames, sinks,
artificial marble, liquid collection pans, etc.



Automatic liquid control pioneer

SOSEY

Domestic base

■ Head office/factory | Sales Department ■ Sales Headquarters (East Japan Area) ■ Central Japan Area ■ West Japan Area

Overseas base

■ SOSEY TAIWAN ■ SOSEY CHINA ■ SOSEY KOREA



■ Dimensional drawing/Name of each part (Unit : mm)

SRCP-101N/103N/105N

SRCP-1800N

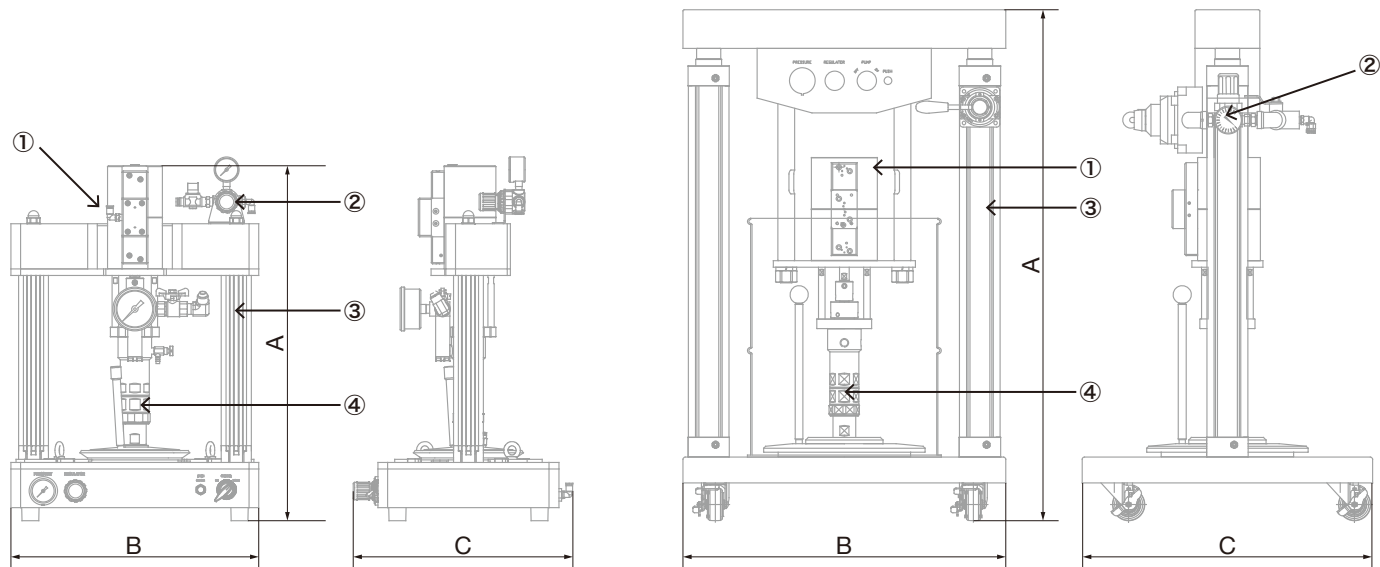

- ① Air motor (for pump operation)
- ② Primary air connection point
- ③ Air cylinder (for pump elevation)
- ④ Pump mechanism section

■ Specifications

※The figures are theoretical design values and do not guarantee the performance of the device.

Model	SRCP - 101N / 103N / 105N		SRCP - 1800N
Boost ratio	10: 1 (20: 1)		20: 1 (10: 1)
Applicable can(s)	101N: 1 kg can / 103N: 3 kg can / 105N: 5 kg can		20 kg pail can
Maximum discharge pressure	7.0 (14.0) MPa		14.0 (7.0) MPa
Discharge volume	20ml / cycle		
Material viscosity	1,000~600,000mPa・s		
Operating pressure	Min0.2~Max0.7MPa		
Air consumption	27L (43L) / min 0.4MPa 60cycle / min		43L (27L) / min 0.4MPa 60cycle / min
Material of the liquid-contacting parts	Chamber Body: AL2024 Seals: UHMW-PE, PTFE, FKM Rod shovel: SUS303F Follow plate: AL2024 Wiper: TPE or NBR		
Material outlet	Rc1/4 (Option: 3/8)		
Input for operating air	Φ6.0		
Weight	18kg		40kg
A (mm)	550		790
B (mm)	384		500
C (mm)	340		450

※Specifications and appearance of the model are subject to change without notice.

※Not explosion-proof or waterproof specifications.

※All specifications other than those mentioned above are considered special specifications (options), so please contact our sales representative for any specific requirements.